

# Ersatzteilliste-Explosionszeichnung

## COOL-LINE-Saladette SL 10

[Art. 435104401]

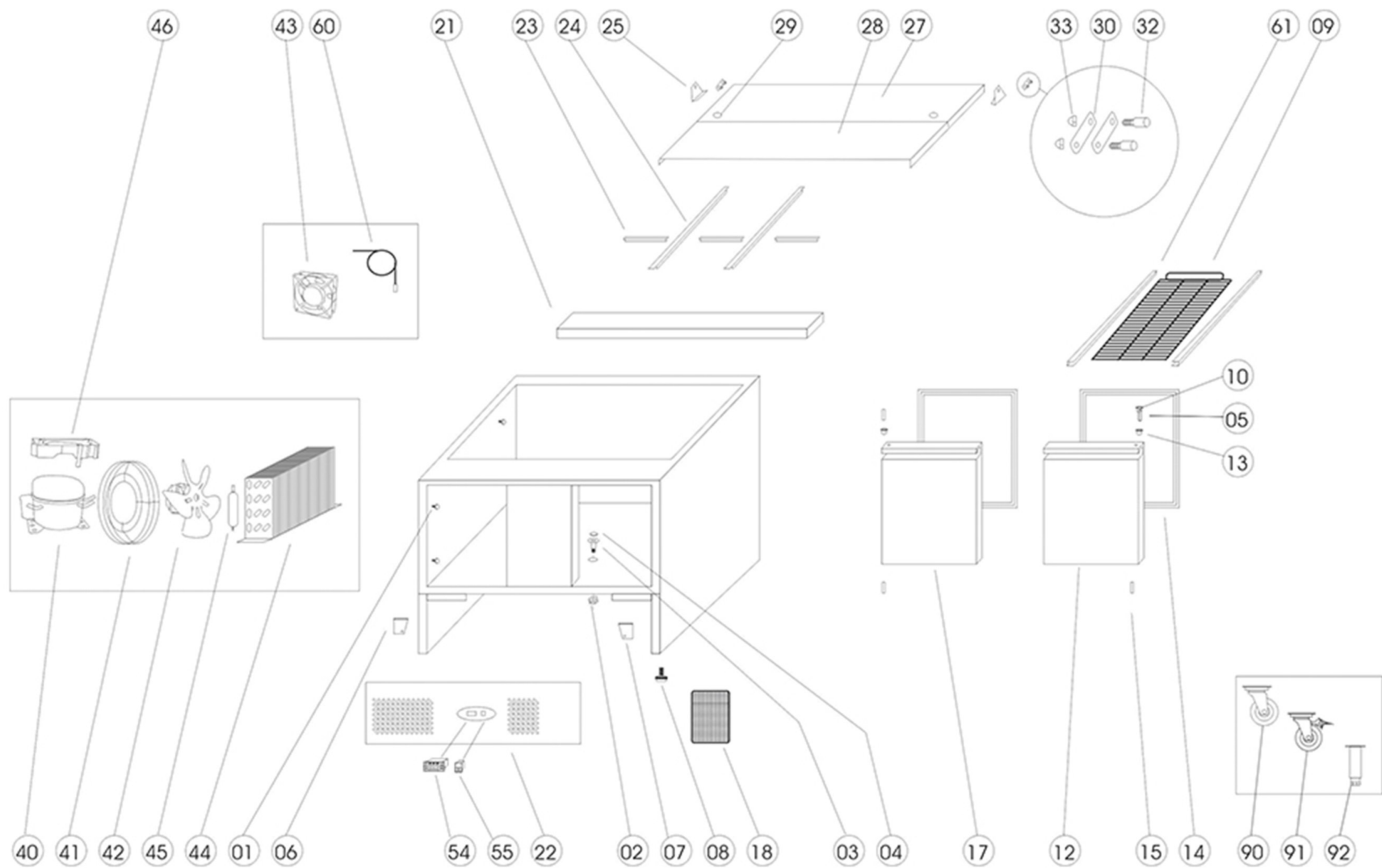



# 16485 / SA1045

Position	ItemNo	Description
01	10112	Support Located Nut
02	11455	Drain Pipe Nut
03	11446	Drain Pipe
04	11453	Drain Pipe Cover
05	13009	Upper Hinge (2 Parts)
06	12830	Down Hinge Left
07	12834	Down Hinge Right
08	14555	Adjustable Feet
09	15055	Shelf 335 x 530
12	12216	Door/Right With Gasket And Hin
13	12780	Door Bushing For 7,6 mm Pin
14	12629	
15	12824	Down Hinge Axis
17	12212	Door/Left With Gasket And Hing
18	10020	Filter 182 x 215 mm
21	16873	Cutting Board 1048x135x20
22	11047	Front Panel
	11086	Front Panel Hexagonal
25	12800	Cover Hinge Right/Left
26	12907	Nut For Cover Hinge Axis
27	10451	Fixed Cover
28	10462	Moving Cover
30	13169	Strengthening Board
32	12795	Cover Hinge Axis
40	11728	Compressor HPKD190A R600
	11802	Compressor OF1350A
41	13309	Basket Guard Grills
42	13384	Condensor Fan BD01-01/170
43	13318	Cond./Evap. Fan Rah1238B
44	14118	Condenser
45	15724	Filter Drier 25 G
46	11590	Water Pan (Plastic)
54	14060	Thermostat XR02CX 2 Probe Blue
55	13754	Main Switch
60	13896	Probe NTC Dixell/Carel 10 Kohm
61	12514	Guides (Set) 550x20x20
90	14631	Castor 60 mm Without Brake
91	14630	Castor 60 mm With Brake
92	14604	Leg 85-115

2022-04-22

**Finanzen/Service**  
**28307 Bremen**  
Thalendorststraße 15  
Tel.+49 421 48557-0  
Fax+49 421 488650  
bremen@nordcap.de

**Vertrieb Ost**  
**12681 Berlin**  
Wolfener Straße 32/34, Haus K  
Tel.+49 30 936684-0  
Fax+49 30 936684-44  
berlin@nordcap.de

**Vertrieb West**  
**40699 Erkrath**  
Max-Planck-Straße 30  
Tel.+49 211 540054-0  
Fax+49 211 540054-54  
erkrath@nordcap.de

**Vertrieb Nord**  
**21079 Hamburg**  
Großmoorbogen 5  
Tel.+49 40 766183-0  
Fax+49 40 770799  
hamburg@nordcap.de

**Vertrieb Süd**  
**55218 Ingelheim**  
Hermann-Bopp-Straße 4  
Tel.+49 6132 7101-0  
Fax+49 6132 7101-20  
ingelheim@nordcap.de



[www.nordcap.de](http://www.nordcap.de)