



*Neumärker*

Lohstr. 13 - 58675 Hemer / Postfach 4063 - 58663 Hemer  
Telefon: +49 2372 9274-0 Fax: +49 2372 3304  
DEUTSCHLAND

# Explosionszeichnung

## **Roll-In Kettentoaster**

**Art.-Nr. 05-50902N**

[www.neumaerker.de](http://www.neumaerker.de)

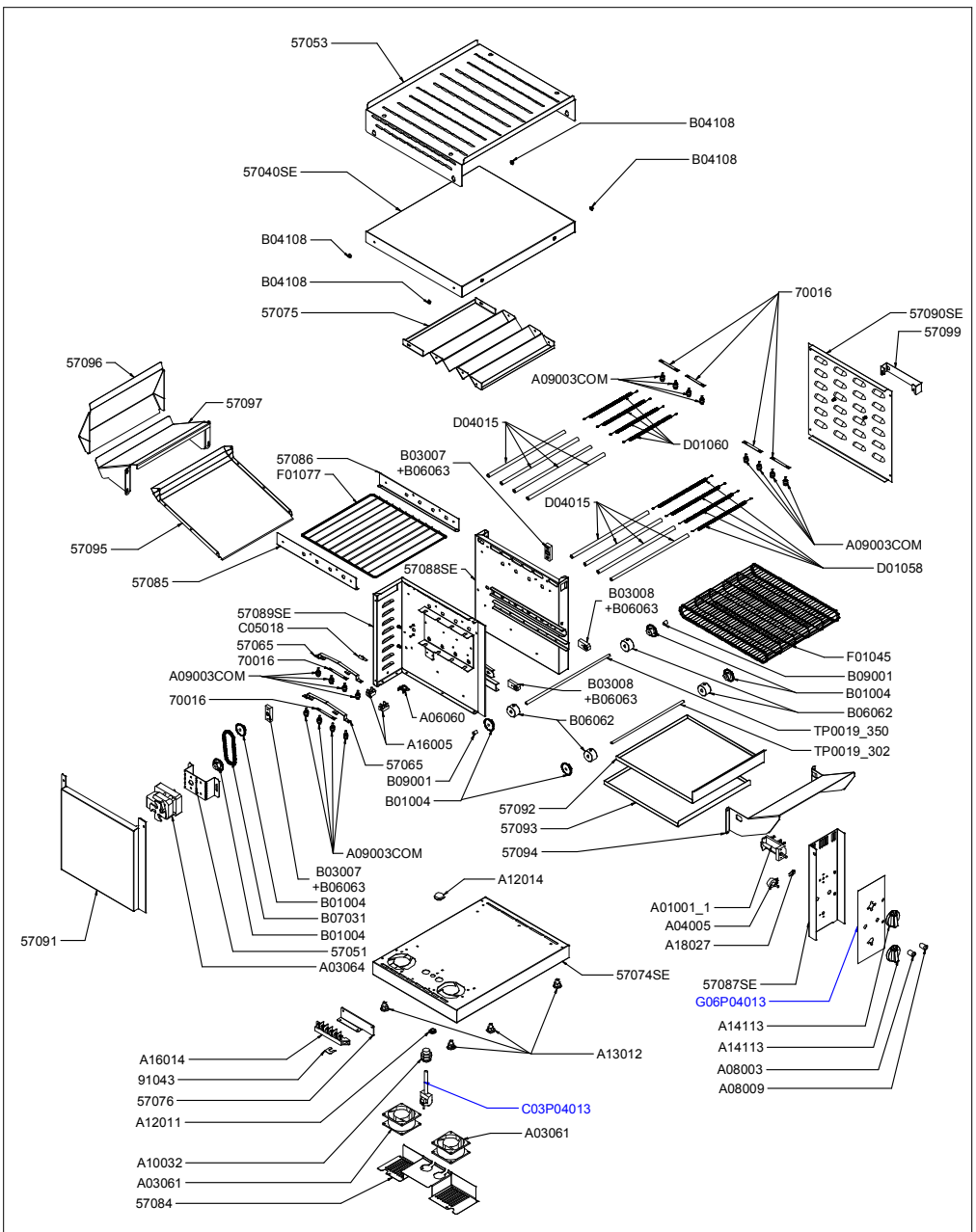

Date :  
06/10/2014

Date :  
16/03/2015

Indice  
B

CODE	QTE	SPARE PART
57040SE	1	ROOF ASSEMBLY CT 3000
57051	1	MOTOR HOLDER CT 3000
57053	1	ROOF PROTECTION CT 3000
57065	2	ELEMENT CONNECTOR CT 3000
57074SE	1	BASE ASSEMBLY CT 3000 B
57075	1	PARABOLIC REFLECTOR CT 3000 B
57076	1	TERMINAL HOLDER CT 3000 B
57084	1	VENTILATOR COVER CT 3000 B
57085	1	LEFT TUBES PROTECTION GRID HOLDER CT 3000 B
57086	1	RIGHT TUBES PROTECTION GRID HOLDER CT 3000 B
57087SE	1	CONTROL PANEL CT 540 B
57088SE	1	UPRIGHT SMALL ASSEMBLY CT 540 B
57089SE	1	UPRIGHT HIGH ASSEMBLY CT 540 B
57090SE	1	UPRIGHT SMALL PANEL CASING CT 540 B
57091	1	UPRIGHT HIGH PANEL CASING CT 540 B
57092	1	REFLECTOR TRAY CT 540 B
57093	1	DRIP TRAY CT 540 B
57094	1	LOADING TRAY 30 ° CT 540 B
57095	1	BOTTOM REAR REFLECTOR CT 540 B
57096	1	TOP REAR REFLECTOR CT 540 B
57097	1	UNLOADING TRAY 60 ° CT 540 B
57099	1	STOP UPRIGHT SMALL PANEL CASING CT 540 B/CT 3000 B
70016	6	ELECTRICAL CONNECTOR
91043	1	TERMINAL CONNECTOR
A01001/1	1	COMMUTATOR 4924215001
A03061	2	VENTILATOR CT 3000
A03064	1	MOTOR CT 3000
A04005	1	POTENTIOMETER CT 540/CT 3000
A06060	1	SAFETY THERMOSTAT 45 °
A08003	1	ORANGE PILOT LIGHT DIAM 12
A08009	1	GREEN PILOT LIGHT DIAM 12
A09003COM	16	STEATITE ASSEMBLY
A10032	1	CORD CLOSER
A12011	1	CABLE SHOE CREPE MACHINE DA 110
A12014	1	HOLDUP SR 1765 RF16
A13012	4	HEXAGON JACK M10x20
A14113	2	ELECTRIC KNOB 9 H
A16005	2	SLIDE 2 PIN PA 27/2 RF 4/6/10
A16014	1	6 HOLES DOMINO
A18027	1	DIODE FOR CT540/CT300/ GYROS
B01004	6	GEAR WHEEL CT 540/CT 3000
B03007	2	BACK BEARING CT 3000
B03008	2	FRONT BEARING CT 3000
B04108	4	SCALE STRAP
B06062	4	GUIDE WHEEL CT 3000
B06063	4	SMOOTH BEARING CT 3000 B
B07031	1	CHAIN CT 3000
B09001	2	SPACER DIAM EXT 10 LG 12 MM
C03P04013	1	CORD
C05018	1	EQUIPOTENTIAL TERMINAL
D01058	4	BOTTOM HEATING ELEMENT CT 3000
D01060	4	TOP HEATING ELEMENT CT 3000 B
D04015	8	QUARTZ TUBE CT 540/ CT 3000 (320x7x11)
F01045	1	METALLIC GRID CT 540/CT 3000
F01077	1	TUBES PROTECTION GRID CT 3000 B/CT 540 B
G06P04013	1	FRONT PANEL
TP0019_302	1	FRONT AXIS
TP0019_350	1	REAR AXIS

Date :  
06/10/2014

Date :  
16/03/2015

Indice  
B